



Queens Drive, W3

At over 1,000 sq. ft, this spacious and beautiful three-bedroom apartment located within this iconic Tudor style development which forms part of the Hanger Hill Garden Estate has been nicely refurbished throughout. The property also benefits from newly installed windows.

The flat is ideally located for the Central, Piccadilly and Elizabeth Lines.

Thanet Court is surrounded by deep landscaped gardens and further benefits from off-road parking, a garden storage shed, a long lease (974 years remaining) and share of freehold.

- Three-bedroom apartment
- Over 1,000 sq ft
- Long lease (974 years remaining)
- Share of freehold
- Off-street parking and small shed
- Beautiful shared gardens
- Ideally located for public transports and motorists
- Quiet location

£625,000

Thanet Court

Approximate Gross Internal Area
1012 sq ft - 94 sq m

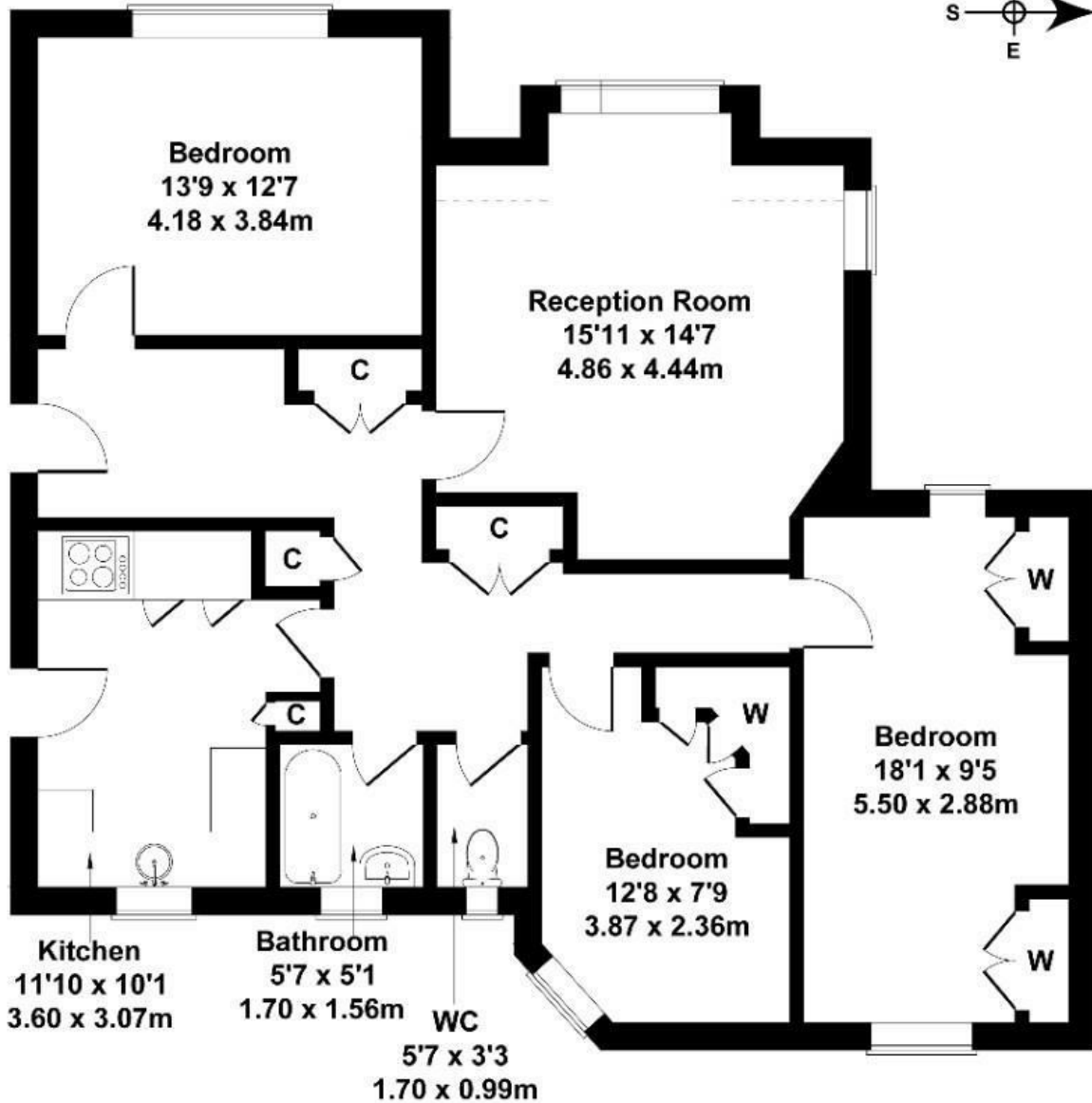
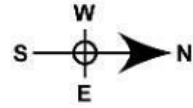

SECOND FLOOR

Not to Scale. Produced by The Plan Portal 2024
For Illustrative Purposes Only.

Energy Efficiency Rating		
	Current	Potential
<i>Very energy efficient - lower running costs</i>		
(92 plus) A		
(81-91) B		
(69-80) C		69
(55-68) D	56	
(39-54) E		
(21-38) F		
(1-20) G		
<i>Not energy efficient - higher running costs</i>		
England & Wales	EU Directive 2002/91/EC	